

*Solutions that make you smile.* 😊

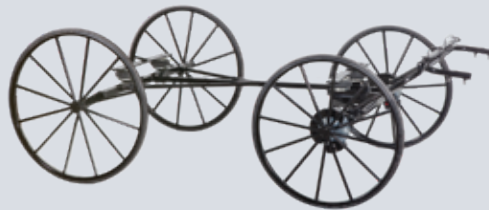

**PARTS CATALOG**  
**2025**



**CONTENTS:**

Torsion Gears..... 4-9  
Gear Reference Diagram ..... 6-7  
Undercarriage Weight  
Comparison ..... 8  
Wheels & Accessories..... 10-11  
Torsion Gear Accessories  
& Replacement Parts..... 12-15

Air Bag Kit & Parts ..... 16  
Air Compressor & Parts ..... 17  
Disc Brakes & Parts..... 18-21  
Brake Fittings ..... 21  
Miscellaneous Buggy Parts..... 22  
Automotive Paints & Primers ..... 22  
Tax Form & Order Forms ..... 23-27



## Welcome!

Welcome to our 2025 parts catalog. We hope this find you and your family active and healthy.

We thank God for the blessings He showers us with everyday. What would we have today if we were given only what we thanked Him for yesterday?

A hearty Thank You extended to all of our customers. We value your support and feedback as we continue to strive for excellence in innovation, quality, and service.

Blessings Wished!

The CMS Crew

## About Us

A family owned and operated business since 1979, nestled in the heart of Lancaster County, Carriage Machine Shop manufactures quality carriages and parts, while offering friendly customer service.

## Where to Find Us

Carriage Machine Shop, LLC  
250 Maple Ave.

Bird-in-Hand, PA 17505

**717-397-4079**

**717-397-4085 (fax)**

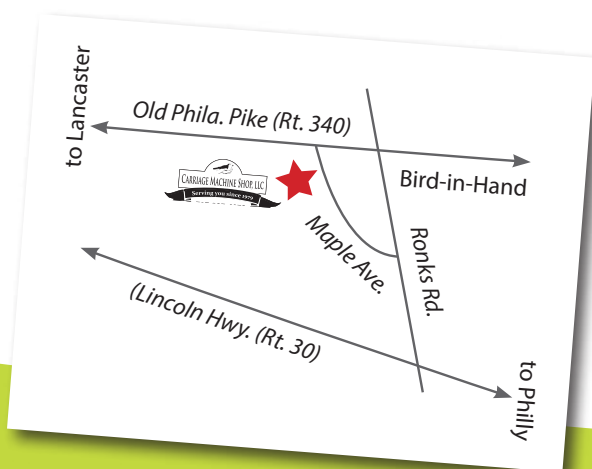

## Terms & Conditions

### RETURNS:

No returns will be accepted unless authorized by a representative of CMS LLC. Merchandise will be credited when it is in our warehouse. Return shipping costs must be prepaid. A 25% restocking fee applies to all returned or refused merchandise. No returns will be accepted after 30 days unless upon agreement. Items to be returned must be in original condition.

### SHIPPING DAMAGES:

Shipping damages must be reported within 24 hours of delivery. Please keep your item and all packing materials for possible inspection. If the item returned under this clause is found to be perfect and in full working order, it will be returned to you and an administration fee of 15% of the purchase price plus the shipping cost back to you will be charged.

### 12 MONTH LIMITED WARRANTY:

Parts from CMS LLC are warranted for a period of 12 months from the date of manufacture, subject to the terms & conditions as follows:

- CMS LLC will repair or replace any part which is defective or becomes faulty within a period of 12 months from purchase, provided it is returned to us, shipping paid, and that the part has only been used in the normal and correct way. We reserve the right to change/improve specifications from time to time without notice. **Any repairs or modifications performed by anyone other than CMS LLC automatically voids this warranty.**
- Labor: The owner may at his option and with CMS LLC approval, have the defective part shipped to the shop for repair. All labor and material costs for repair at the shop will be borne by CMS LLC, but the owner assumes all shipping costs. **Should the owner choose a source other than CMS LLC to repair the part, this warranty will be voided and CMS LLC no longer assumes responsibility for the part.**
- Warranty applies to original owner only.
- **Steel wheels have a 6-Year Pro-Rated Limited Warranty.** See page 11 for details.

### TERMS:

Wholesale accounts get 1% discount when paid in 10 days, net 30. Retail customers payment is due upon receipt.

### NOTICE:

Carriage Machine Shop will not be liable or responsible for any type of accident that may arise from any of our products. Use all of our products at your own risk.



# Improving Since 1979.

**Carriage Machine Shop** opened its doors in 1979 to begin manufacturing 2-wheeled carts for the pleasure driving market. As that market began to diminish around 2006, we shifted our focus to increase Amish and Mennonite buggy parts manufacturing. Since that time, we have spent considerable energy in developing and refining the steel wheel, undercarriages, and disc brakes. Enjoy a quiet drive through the history of CMS product improvements...



## CMS Disc Brakes

CMS began manufacturing steel wheels & installing disc brakes on pleasure carriages.

2006

Installed an imported British disc brake system on an Amish carriage, which lasted only two years under rugged use.

2008

After extensive research, we partnered with an American company to design a **disc brake system to fit Amish carriages**.

2010

Stainless steel discs were getting hot and eating up the brake pads, so we **switched from stainless steel to regular steel** discs.

2011

Upgraded from 3/16" disc to 1/4" disc. The **thicker disc eliminated some noise** and had better wear.

2012

Switched pad material due to screeching brakes.

2013

To remedy issues with drag and rattle, CMS **developed a 3 spring pad system**. This helped, but didn't completely resolve.

2014

**Added new style pull back springs** to calipers which eliminated rattle & dragging brakes.

**Old disc covers trapped & amplified noise**. We found that a more open design significantly reduced road noise.

2015

**Changed caliper mount** to eliminate movement on the axle caused by vibration and to make installation easier.

2016

**Celebrated 40 years** in business with gratitude to our customers!

2019

Switched to **plastic disc covers** to reduce weight & price.

2022

2024

## CMS Steel Wheel & Undercarriages

**CMS purchased Bellcrown Carriages** who manufactured steel wheels in England for over 30 years for the pleasure carriage industry.

Responding to requests for a quieter ride, CMS began developing a torsion axle undercarriage system with airbag suspension and steel wheels.

**Strengthened the outside wheel channel** to prevent flat spots.

**Tested** the torsion axle w/ airbags, steel wheels & disc brakes **on our personal carriages**. Friends & neighbors began asking for a test drive which led to our first orders.

**Added a zinc-rich epoxy primer** to the powder coating process to prevent rusting underneath the top coat.

**Investigated and adjusted welding temperature** and how it relates to occasional spoke breakage.

Redesigned the regular long hub for a **cleaner look & lighter weight**.

**Modified our welding technique** to remedy broken welds on the outside steel tire.

Developed NEW style torsion to **allow about 200% more range of motion**, which provides a smoother ride.

**Reduced weight** by redesigning the torsion and the front fifth wheel.

Switched to **Jasper rubber** on all wheels with rubber tire, which is proving to be more durable.

**Started branding as CMS** 

Implemented **Pivot Up Shaft Stop** to keep shafts from hitting carriage.

Started **stamping date** into wheels for tracking purposes.

Switched to **aluminum shaft fronts** to reduce weight and prevent a price increase.

Introduced the new **CMS Spring Tree**.

**Increased wall thickness** by 30% on aluminum shaft fronts to improve durability.



# #5200 Torsion Gear

Available w/ Airbags or Rubber Shocks



AVAILABLE TO FIT YOUR TOP



AVAILABLE TO SHIP ON A 3' X 6' SKID



USE PAGE 26 FOR EASY ORDERING



**OUR MOST POPULAR GEAR**

(pictured) Gear w/ rubber torsion axle • 5200-AB Airbag Suspension • 5532 Disc brakes w/ 5100-P covers • 5300 Pivot-up steel shafts • 5502-RFR 36" x 40" steel wheels w/ rubber & flat steel rim • 409 lbs.

### NOW STANDARD

#### Pivot-up Shaft Stop

Now you can fold up your shafts without worrying that it will rub against your carriage top.



### Rear Axle Set-ups:

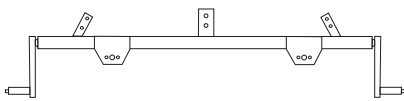

#### 5200-AB

Medium airbags in front & rear, choice of spindles. Most popular setup for most any size carriage or small surrey. *Specify box length & width.*

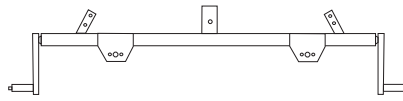

#### 5201-AB

Medium airbags in front & rear, choice of spindles. Rear airbags are set up wider for spring wagons, surreys, or pick-ups. *Specify hub centers for length and rear airbag centers.*

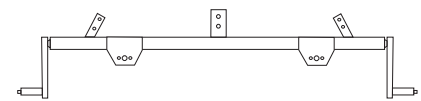

#### 5204-AB

Set-up for market wagons, spring wagons, or surreys. Spring in front, medium airbags in rear, choice of spindles. *Specify center of front spring to center of rear axle, and rear airbag centers.*

5200-RS Rubber shocks instead of airbags

5201-RS Rubber shocks instead of airbags

5204-RS Rubber shocks instead of airbags



(pictured) Gear w/ rubber torsion axle • 5200-RS Rubber Shock Suspension • 5532 Disc brakes w/ 5100-P covers • 5300 Pivot-up steel shafts • 5502-RFR 36" x 40" steel wheels w/ rubber & flat steel rim • 409 lbs.



Find more Gear Options on p. 9

### Spindles Available

Regular 1 1/8" long spindle



Regular 1 1/8" short spindle



CMS 1 1/4" short spindle for CMS hubs.



# Torsion Gear w/ Spring



AVAILABLE TO FIT YOUR TOP



AVAILABLE TO SHIP ON A 3' X 6' SKID



USE PAGE 26 FOR EASY ORDERING

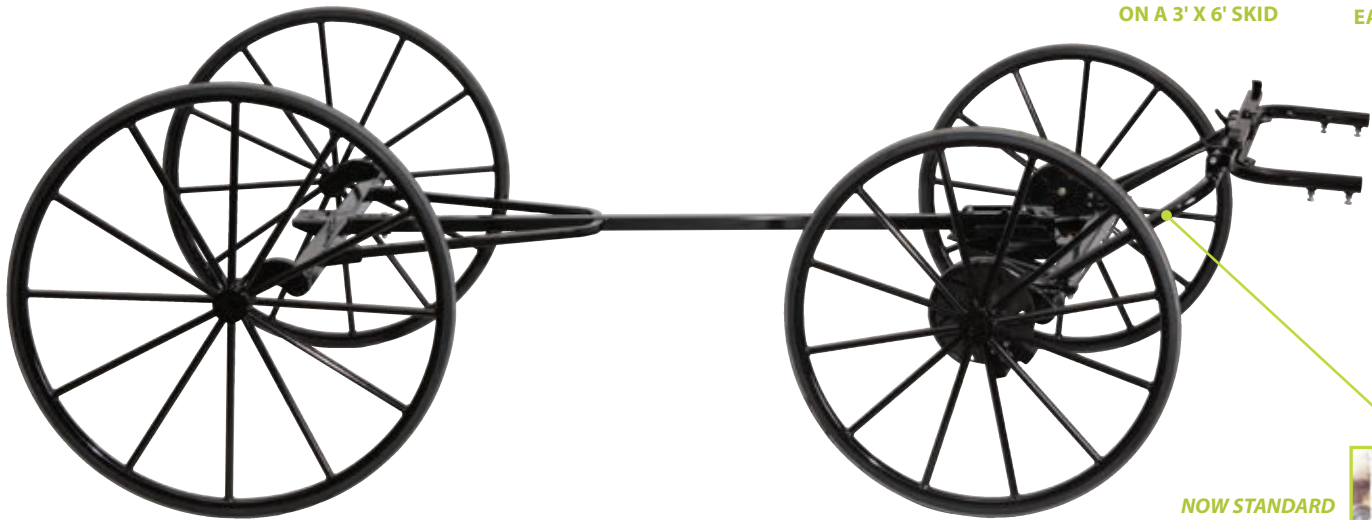

(pictured) Gear w/ rubber torsion axle • 5205 Spring attachment • 5532 Disc brakes w/ 5100-P covers • 5300 Pivot up steel shafts • 5502-RFR 36" x 40" Steel wheels w/ rubber & flat steel rim • Weight 465 lbs (weight includes springs)

**NOW STANDARD**

**Pivot-up Shaft Stop**

Now you can fold up your shafts without worrying that it will rub against your carriage top.



## Rear Axle Set-ups:

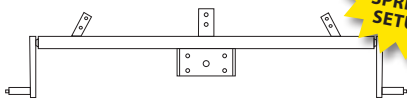

**5205** Set-up for single or double carriage with springs (front & rear). Rear spring mounts behind the axle to shorten wheel base. Wooden block not needed to mount springs. *Specify spring centers.*

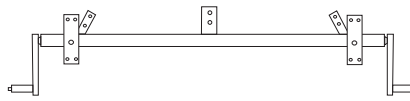

**5207** Set-up for side springs on pickups, spring wagons, or surreys. *Specify center of front spring to center of rear axle, and rear spring centers.*

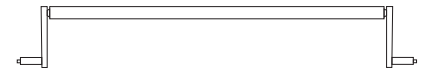

**Custom Cart Axle w/Torsion 5214** Choose spindles, mounting brackets & axle length. *Specify cart body width, wheel track width, and what type of attachment to mount body.*

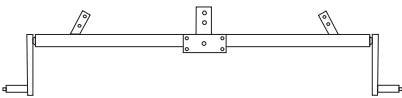

**5206** Set-up for single or double carriage with springs (front & rear). Rear spring mounts on top of axle. Wooden block not needed for rear axle. *Specify spring centers.*

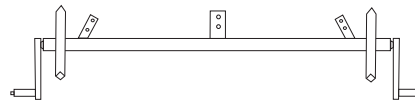

**5208** Set-up for double half elliptic springs on market wagons. *Specify center of front spring to center of rear axle.*

**\*NOTE: Spring Gears are made to fit 1 1/2" springs. Springs are NOT included.**

### Shaft Attachments

Tabs for regular wooden or fiberglass shafts



### Disc Brakes

w/ covers on CMS 1 1/4" hub



### Fifth Wheel

Wooden block not needed to mount spring



### 5205 Rear Spring Mount

Wooden block not needed to mount spring



Parts List for:

**5200-AB Torsion Axle Undercarriage**

5502-RFR 36x40 Steel Wheels, 5300 Pivot-up Shafts,  
5532 Disc Brakes, 5100-P Disc Covers, 5559 Master Cylinder

ID	Part #	Description	QTY
1	5017	Hubcap - CMS 1 1/4"	4
2	5295	Cotter Pin	4
3	5168	Axle Nut for CMS 1 1/4" axle	4
4	5170	Axle Washer for CMS 1 1/4" axle	4
5	5283	Bearings for CMS 1 1/4" axle	4
6	5286	Oil Seal for CMS 1 1/4" axle	4
7	3034	Flat Socket Head Cap Screw 3/8 x 1"	8
8	5372	Aluminum Plate - Rear	1
9	5086	Airbag	4
10	3018	Nylon Lock Nut - 3/8"	21
11	3023	Hex Bolt 3/8 x 1" SS	8
12		Rear Axle	1
13	3024	Hex Bolt - 3/8" x 1 3/4"	4
14	5502-RFR	Rear Wheel	2
15	5227	Perch Plate Rear	1
16	3029	Hex Bolt - 3/8" x 2 1/2"	2
17	5217	Perch	1
18	5218	Perch Plate for Airbags	1
19	3025	Perch Bolt - 3/8" x 2 3/4"	2
20	5043	Metal Disc	2
21	3033	Socket Head Cap Screw 6mm x 3/4"	12
22	5186	Disc Cover - Rubber	4
23	5100-P	Disc Cover - Plastic	2
24	3102	Flat Washer 3/8"	8
25	3101	Split Washer 3/8"	4
26	3046	Hex Bolt 3/8" x 3/4"	4
27	5371	Aluminum Plate - Front	2
28	3005	Fender Washer 3/8"	4
29	5045	Caliper 1/4"	2
30	3028	Hex Bolt - 3/8" x 1 1/4" Grade 8	4
31	5171	Kingpin Bolt	1
32	5224	Fifth Wheel Top Plate	1
33	5228	Fifth Wheel Wafer	1
34		Front Axle	1
35	5161	Mudsplasher Rod	1
36	3038	Hex Bolt - 3/8" x 1 1/4" Grade 5	4
37	5502-RFR	Front Wheel	2
38	5236	Mudsplasher Hanger Bracket Kit	2
39	5034	Pivot-up Shaft Heel	1
40	5257	Pivot up Shaft Bushing	4
41	5425	Brake Tubing Kit	1
42	5187	Round End Cap - Rubber	2
43	5261	Pivot-up Shaft Receiver	1
44	3023	Hex Bolt - 3/8" x 1"	4
45	3019	Regular Nut 3/8"	4
46	5262	Singletree Washer	1
47	5260	Steel Single Tree	1
48	3017	Single Tree Bolt	1
49	5302	Shaft Fronts - Aluminum	2
50	5080	Hubcap Wrench	1
51	5559	Master Cylinder	1

\*Parts may vary based on your order.

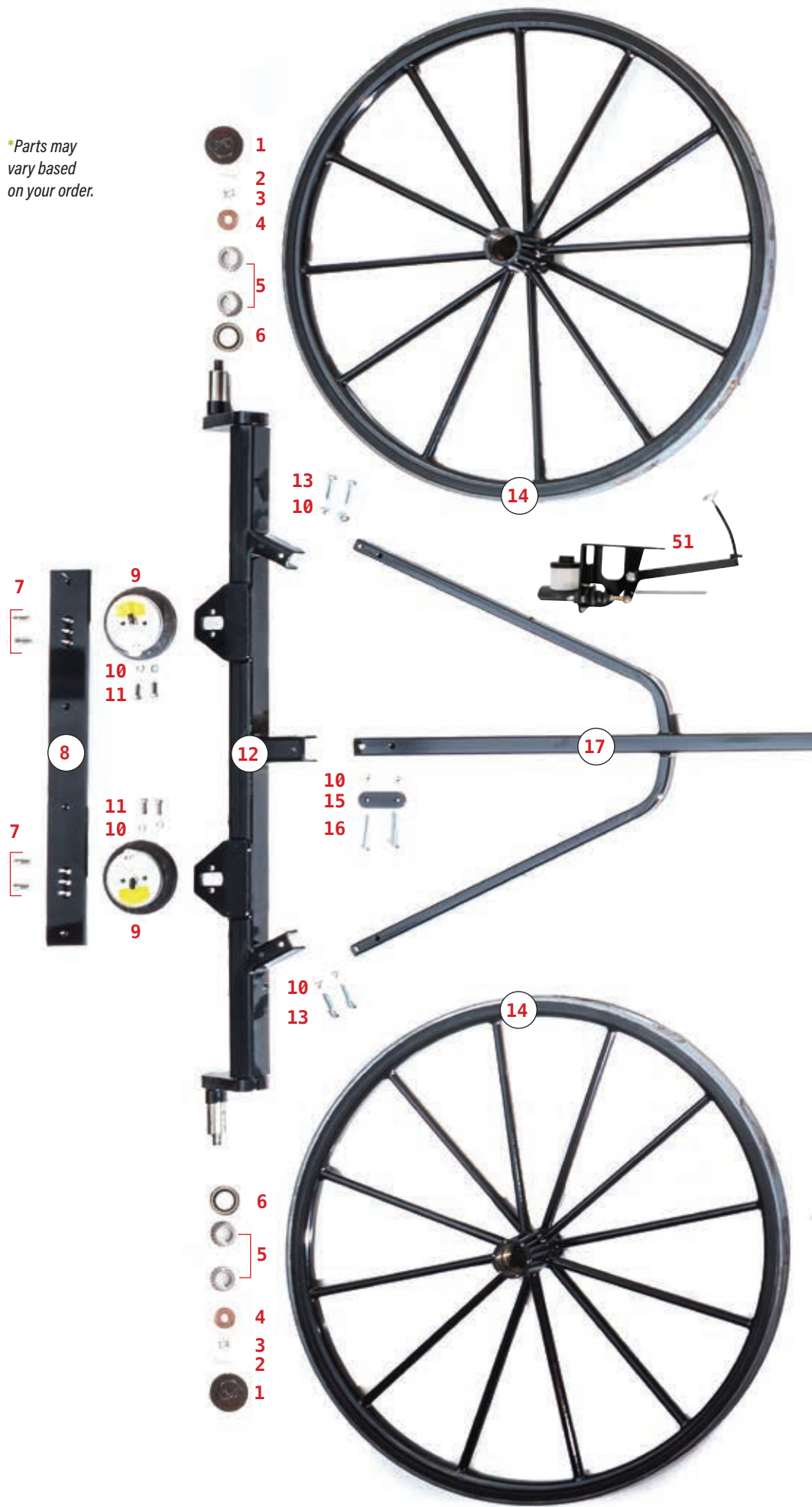

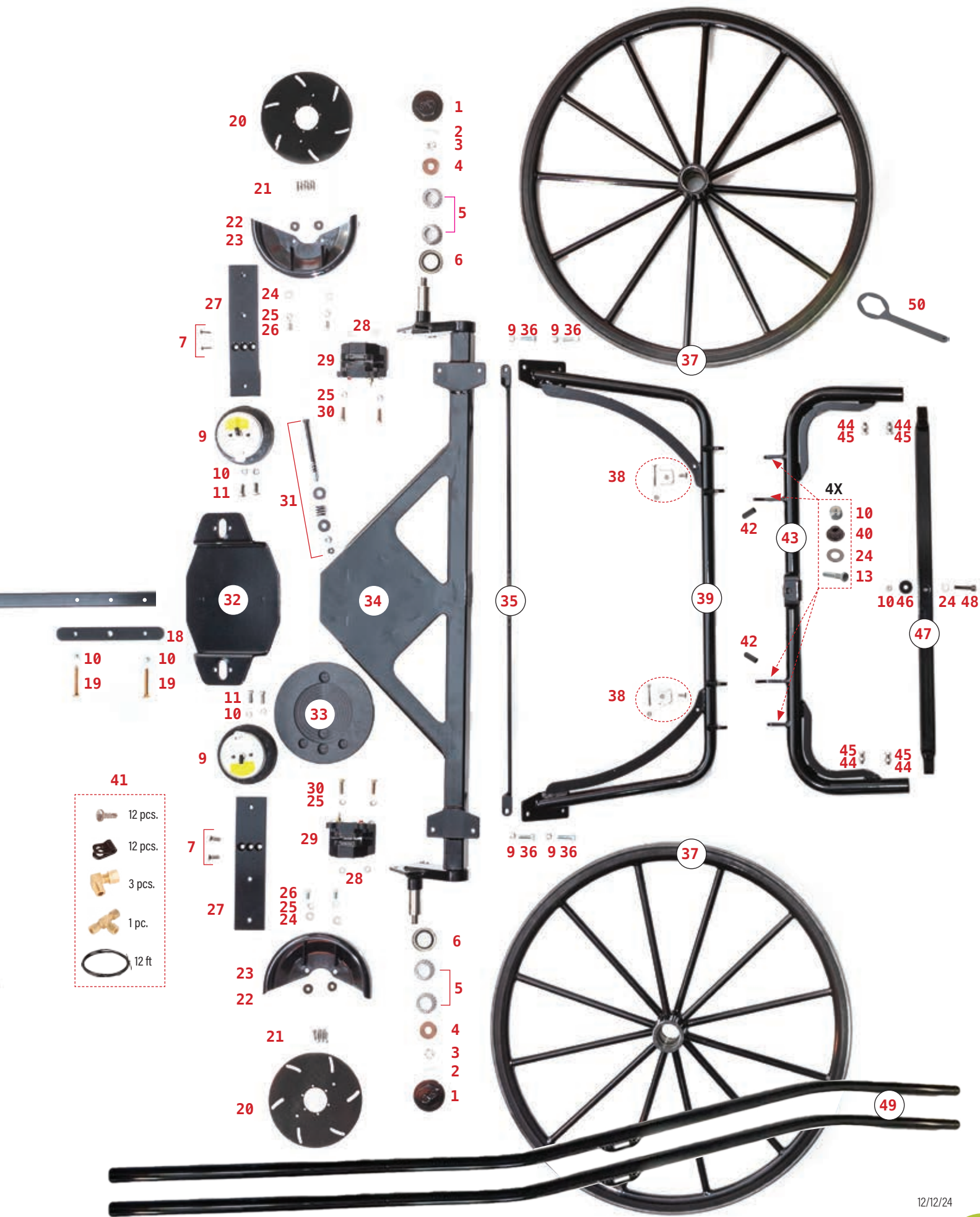

- 41
- 12 pcs. [Screw]
  - 12 pcs. [Nut]
  - 3 pcs. [Bushings]
  - 1 pc. [Bushings]
  - 12 ft. [Feet]

# Straight Axle w/ Spring



AVAILABLE TO FIT YOUR TOP



AVAILABLE TO SHIP ON A 3' X 6' SKID



USE PAGE 26 FOR EASY ORDERING



Steel axle eliminates need for axle clips and is easy to clean!

**NOW STANDARD**

**Pivot-up Shaft Stop**

Now you can fold up your shafts without worrying that it will rub against your carriage top.



(pictured) 5210 CMS Straight Axle (does not have torsion axle) • 5532 Disc Brakes w/ 5100-P covers • 5300 Pivot-up steel shafts • 5502-RFR 36" x 40" steel wheels w/ rubber & flat steel rim • Weight 421.5 lbs

**Not interested in torsion axle?** ...but still want the benefits of CMS 1 1/4" hub system, pivot-up shafts, disc brakes, and steel wheels? This gear is for you!

Set-ups:

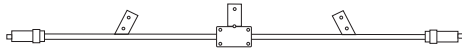

## 5210 Straight Axle Gear

Set-up for single carriage with springs. *Specify spring centers.*

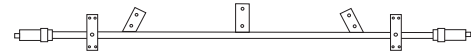

## 5211 Straight Axle Gear w/ side springs in rear

Set-up for side springs on pickups, spring wagons, or surreys. *Specify center of front spring to center of rear axle, as well as rear spring centers.*

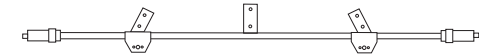

## 5212-AB Straight Axle Gear w/ Airbags in rear

Set-up for market wagons, pickups, spring wagons, or surreys. *Specify center of front spring to center of rear axle, as well as rear airbag centers.*

Rubber Shock...  
5212-RS



Rubber shocks may be substituted for airbags



## Comparing Weight to a Traditional Gear

	TRADITIONAL	CMS UNDERCARRIAGE
suspension & axles	1" straight axles w/ EZ Ride Springs	CMS Straight Axle w/ 1 1/4" axle stubs & leaf spring attachment • <b>Larger bearings allow easier rolling &amp; last longer</b> • <b>Eliminates need for axle clips</b>
wheels	Wooden w/ channel rubber & flat steel	Steel w/ rubber & flat steel • <b>Low maintenance &amp; durable</b> • <b>Avoid annual re-hooping</b>
brakes	7" drum	Disc w/ covers • <b>Smooth &amp; consistent brake action</b> • <b>Uniform pad movement prevents wheels from sliding</b>
shafts	Fiberglass	Pivot up steel • <b>Eliminates downward pressure on horse's back (Testing has shown a 75% reduction)</b> • <b>Aluminum shaft fronts</b>
<b>TOTAL WEIGHT</b>	<b>405 LBS.*</b>	<b>421.5 LBS.*</b>

\*Weights INCLUDE EZ Ride Springs w/ mounting brackets, etc.

Find more Gear Options on p. 9

### Disc Brakes

Installed on front axle (pictured). Also available on rear axle.



### Fifth Wheel Spring Mount

Wooden block NOT needed to mount spring



**NEW DESIGN**

### Rear Axle Spring Mount

Wooden block is NOT needed to mount spring.





## Gear Options At-A-Glance

● = standard  
○ = optional  
NA = not available



Torsion w/ Air Bag      Torsion w/ Spring      Straight Axle w/ Spring

	Torsion w/ Air Bag	Torsion w/ Spring	Straight Axle w/ Spring
Rubber torsion axle	●	●	NA
Straight back torsion	○	●	NA
Regular angle torsion	●	○	NA
Steel perch	●	●	●
Air bags or rubber shocks ( <i>front &amp; rear</i> )	●	NA	NA
Air bags or rubber shocks ( <i>rear, spring in front</i> )	NA	○	○
Heavy duty fifth wheel w/ nylon wafer	●	●	●
Steel wheels	○	○	●
CMS 1 1/4" spindles ( <i>only fits the CMS 1 1/4" hub &amp; disc brakes</i> )	○	○	●
1 1/8" long spindles	○	○	NA
1 1/8" short spindles	○	○	NA
CMS disc brakes	○	○	●
Disc covers	○	○	●
Hydraulic drum brakes ( <i>only available on 1 1/8" long or short spindles</i> )	○	○	NA
Pivot up shafts	○	○	●
Tabs for regular shafts	○	○	NA
Pivot up shaft stop	●	●	●
Custom shaft attachments	○	○	NA
Attachment for side springs	NA	○	○
Attachment for double half elliptic springs	NA	○	NA
Made to fit any carriage top ( <i>Call us with specs</i> )	●	●	●
Durable powder coating	●	●	●
5th Wheel Stop	○	○	○

Write your order notes here  
so when you re-order, it's easy!

## Installation Tips:



### Airbag Gear

- **Recommended air pressure** will vary due to weight and style of carriage top being used. 15 to 20 PSI is recommended for Lancaster County.
- When installing a **#5200 gear**, you will want to **hook up the airbags side to side**, meaning left rear and left front airbag to one gauge, then the same for the right side.
- Very important! Anytime you install airbags, **be sure to cut the ends of the tubing straight**. If they are not cut straight, they will leak!
- **Use Loctite Thread Sealant 545 (CMS part# 5451)** on all air fitting threads.
- **Check all wheel bearings** installed by CMS **for tightness to your specs**. We tighten them at the shop, but as you know, wheel bearings can loosen once broken in.

### Spring Gear

- When installing a **#5205 gear** or any of our gears with spring, you will need to **supply your own springs, spring blocks, clip bars, bolts, and hangers**.
- **Check all wheel bearings** installed by CMS **for tightness to your specs**. We tighten them at the shop, but as you know, wheel bearings can loosen once broken in.

### Disc Brakes

- **Use Loctite Thread Locker 263 (CMS part# 5450)** on all disc brake bolts, especially on the disc and #5342 Caliper Bracket. Use sparingly!
- **Do NOT overtighten bolts** when installing Disc Brakes. You will only stress the bolt and cause premature failure.
- **CMS Disc Brakes work best** when used with a **Master Cylinder without a check valve**. CMS #5559 already has the check valve removed. When using a master cylinder from a vendor other than CMS, please remove the check valve.

# Wheels



Rigorous powder coat process for maximum coating adhesion.

✓ Please specify size when ordering.



## PARTNER KEYSTONE COATING KEEPS YOUR WHEELS PROTECTED

Every Carriage Machine wheel receives the same process at Keystone Coating.

They first **blast the wheels using steel grit** to ensure the metal is cleaned and ready for coating. The workhorse of protection is a **zinc-rich epoxy primer coating** applied to the wheel, creating a barrier from rust and other corrosive materials. This has been **proven to greatly extend the life by up to 4 times!**

Finally, a **top coat of polyester powder coating** is applied giving your wheels a beautiful high-gloss finish with approximately **6-8 mils of protection** from the harsh elements.

Other services offered by Keystone Coating:

- Blasting
- Masking of parts to protect certain areas from powder
- Quality control personnel
- Value added services (i.e. packaging, minor assembly, etc)
- Delivery
- Environmentally responsible option vs. wet paint



Steel Wheel – Long Hub <i>fits PA 1" or 1 1/8" long spindle axle</i>		Weight
5500-NONE	No Rubber or Steel	29 lbs
5500-ROH	1 ¼ Half Round Jasper Rubber	34 lbs
5500-ROF-J	1 ¼ Flat Top Jasper Rubber	34 lbs
5500-ROF-T	1 ¼ Flat Top TBP Rubber	34 lbs
5500-RFR	1 ¼ Flat Top TBP Rubber and 3/8 x 1 3/8" Flat Steel Rim	51 ½ lbs
5500-RFR-LP	Low Profile TBP Rubber and 3/8 x 1 3/8" Flat Steel Rim	51 ½ lbs
5500-RHR	1 ¼ Flat Top TBP Rubber and 1 1/8" Half Round Steel Rim	51 ½ lbs
5500-RHR-LP	Low Profile TBP Rubber and 1 1/8" Half Round Steel Rim	51 ½ lbs



Steel Wheel – Flush Hub <i>fits PA 1" or 1 1/8" short spindle axle</i>		Weight
5501-NONE	No Rubber or Steel	29 lbs
5501-ROH	1 ¼ Half Round Jasper Rubber	34 lbs
5501-ROF-J	1 ¼ Flat Top Jasper Rubber	34 lbs
5501-ROF-T	1 ¼ Flat Top TBP Rubber	34 lbs
5501-RFR	1 ¼ Flat Top TBP Rubber and 3/8 x 1 3/8" Flat Steel Rim	51 ½ lbs
5501-RFR-LP	Low Profile TBP Rubber and 3/8 x 1 3/8" Flat Steel Rim	51 ½ lbs
5501-RHR	1 ¼ Flat Top TBP Rubber and 1 1/8" Half Round Steel Rim	51 ½ lbs
5501-RHR-LP	Low Profile TBP Rubber and 1 1/8" Half Round Steel Rim	51 ½ lbs



Steel Wheel – CMS 1 ¼" Hub		Weight
5502-NONE	No Rubber or Steel	29 lbs
5502-ROH	1 ¼ Half Round Jasper Rubber	34 lbs
5502-ROF-J	1 ¼ Flat Top Jasper Rubber	34 lbs
5502-ROF-T	1 ¼ Flat Top TBP Rubber	34 lbs
5502-RFR	1 ¼ Flat Top TBP Rubber and 3/8 x 1 3/8" Flat Steel Rim	51 ½ lbs
5502-RFR-LP	Low Profile TBP Rubber and 3/8 x 1 3/8" Flat Steel Rim	51 ½ lbs
5502-RHR	1 ¼ Flat Top TBP Rubber and 1 1/8" Half Round Steel Rim	51 ½ lbs
5502-RHR-LP	Low Profile TBP Rubber and 1 1/8" Half Round Steel Rim	51 ½ lbs

Weights based on 40" wheel with 12 spokes

CMS Channel Profile Rubber  
Rubber fits CMS steel wheels only. Sold by the coil.



1 ¼" Flat Top 5189



1 ¼" Round Top 5190



1 ¼" Low Profile Flat Top 5191

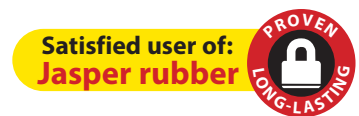

Graber & Canadian custom hubs available upon request.

# Wheel Accessories



Hubcap Wrench  
5080  
For CMS 1 1/4" hubcap



O-Ring  
5082  
For CMS 1 1/4" hubcap



Hubcap - CMS 1 1/4"  
5017  
Fits CMS 1 1/4" hub.  
Painted black.



Hub Cap - EZ Pin  
5070  
Fits PA long hub wheels.  
Powder coated black.



Hubcap - Flush 5076  
Fits PA flush hub wheels.  
Painted black.



Oil Seal  
CMS 1 1/4"  
5286



**Helpful tool**

Oil Seal Driver for  
CMS 1 1/4" oil seal  
5289



CMS 1 1/4" Hub  
w/ Flange for  
Fiberglass Wheel  
5320  
Raw steel. w/ hubcap



Oil Seal  
5284 .....1"  
5285 .....1 1/8"



Bearings  
5282 ..... small (A6075)  
5280 .....1" (07093)  
5281 .....1 1/8" (07100)  
5283 .....1 1/4" CMS



Hub Cover 5294  
for CMS 1 1/4" hub.  
Protects oil seal from  
horse hair, etc. Set of 2.

Bearing Races



5292  
LM67010



5291  
07196



5290  
A6157



We are now using bearings from PEER BEARING. Extensive testing is showing improved performance.

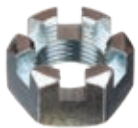

Axle Nut for  
CMS 1 1/4" Axle  
5168



3/16" thick axle washer  
for CMS 1 1/4" axle 5170  
**NEW!** Now using hardened steel to eliminate dishing which caused loose wheels.



Cenpeco Bearing  
Grease 5276



Axle nut for  
Regular Axle  
5167



Axle washer for  
regular axle  
5169



Cotter Pins  
5296 ..... For 1 1/8" axle  
5295 ..... For 1 1/4" axle



## CMS Steel Wheel PRO-RATED WARRANTY



Time elapsed

2 yr	.....	24 month
3 yr	.....	25-36 month
4 yr	.....	37-48 month
5 yr	.....	49-60 month
6 yr	.....	61-72 month

Coverage

<b>FULL</b>
<b>50%</b>
30%
20%
10%

**CMS Steel Wheel Coverage** includes any defect found in the structural soundness of the wheel, under normal use (such as broken spokes, flat spots in channel, cracked hub, etc.) This does NOT include the outer rim, whether it be rubber or steel.

2 yr	.....	24 month
------	-------	----------

**FULL**

**CMS Outer Rim Coverage** on all rubber & steel rim (installed by CMS).

# Torsion Gear Accessories & Replacement Parts

**Perch 5217**  
Powder coated black.  
Specify length and type of gear (air bag or EZ spring).



**Plastic Cap for Perch 3050**  
1 1/2 x 11 ga tubing



**3/8" x 2 3/4" Perch Bolt 3025**  
Grade 8



**Perch Plates**  
Powder coated black

For Airbag Gear **5218**

For EZ Spring **5219**



**Perch Plate, Rear 5227**

**Pivot-Up Shaft Complete 5300**

Includes **5260** Steel Single Tree or you may upgrade to the new Spring Tree **5298-B** or **5298-C**. Powder coated black.



**Shaft Fronts 5302**  
74" long, aluminum, powder coated, 1 pair. Weighs 11.5 lbs.

**Pivot-up Shaft Receivers**

Powder coated black.



For Flex Tree or Soft Tug  
**5033**

For CMS Steel Single Tree or Spring Tree  
**5261**

**Pivot-up Shaft Heel 5034**



**Pivot-up Angle Bracket 5238**

Use to install fiberglass shaft fronts on CMS Pivot-up heel. Pair. Powder coated black.



**Round end cap 5187**  
EPDM Rubber, Black - for pivot up shaft stop



**Mudsplasher Hanger Bracket 5236**

Stainless steel. Bolt onto our Pivot-up Heel or screw to fiberglass or wooden shafts for a sturdy way to hang your mudsplasher.

## Mudsplasher Rods

Powder coated black



For regular tab  
5160



For pivot up shafts  
5161



Mudsplasher, PVC 36" x 29" 5316  
with Aluminum strips top & bottom



Steel Single Tree  
5260

36" overall length. Stainless steel hooks. Powder coated black.

The CMS Spring Tree provides a soft start to your ride and reduces jerking while going uphill. This sleek style has very few components which eliminates rattle and rust. An adapter 5301 is available to mount on wooden or fiberglass shafts.



CMS Spring Tree w/ Black hooks  
5298-B Stainless steel hooks.  
Powder coated black.

CMS Spring Tree w/ Chrome hooks  
5298-C Electro-polished stainless  
steel hooks. Powder coated black.

*Please note: Warranty on spring trees may be voided if safety straps are not installed.*

Strap w/ SS buckle

5145 For spring tree, single tree, and eveners. 1" x 14" size.



Spring Tree Mounting Bracket - Bolt on  
5301 Can be installed on wooden or fiberglass shafts.



Single Tree Washer  
5262 Delrin plastic.  
For single trees on CMS pivot-up.



Singletree Bolt  
3017

*Pivot-up receiver shown w/ 5298-C (installed)*



TG Fender Bracket 5304  
Bolt-on



Pivot-up Plate w/ 1" Tabs 5037  
Fits pivot-up plates welded to the axle. Allows easy conversion from pivot-up shafts to regular double hitch pole. Powder coated black.



Pivot-up Shaft Bushing 5257  
Delrin plastic. Replacement part for the pivot point of your steel pivot-up shafts.



Brackets to install pivot-up on 1" or 1 1/8" regular axle 5263



1" Shaft Spacer 5259  
Delrin plastic. 3/8" hole.



TG Fifth Wheel Top Plate for Spring 5220



Fifth Wheel Wafer 5228



TG Fifth Wheel Top Plate for Spring w/ stops 5235



Kingpin Bolt 5171  
For torsion gear

Changed to 1/2" bolt



TG Fifth Wheel Top Plate for Airbag/Rubber Shock 5224



TG Fifth Wheel Top Plate for Airbag/Rubber Shock w/ stops 5234

Changed to 1/2" bolt

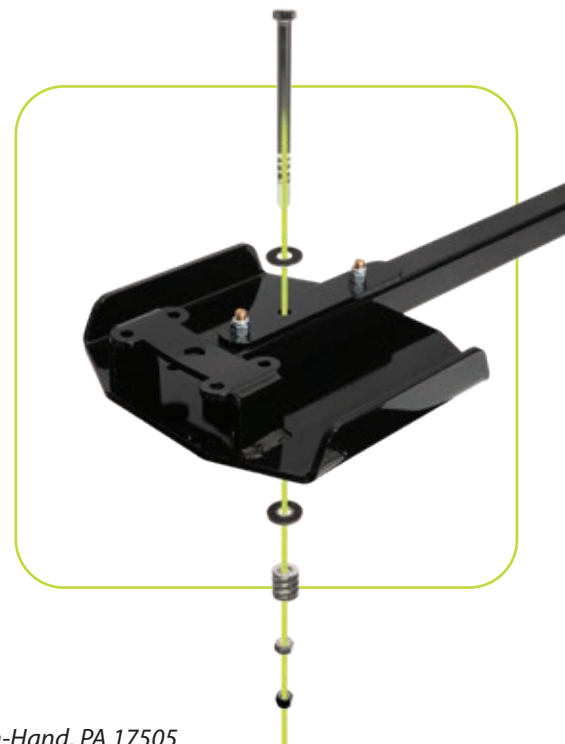



Weld-on Pivot up Plate  
6103  
Raw steel



Weld-on Airbag Mount  
5230 Raw steel



Rubber Shock Plate 1/4"  
5159 to install rubber  
shock on #5200 gear.



Rubber Shock Plate 3/4"  
5166



1 1/8" long spindle 5270  
Fits PA long hub.  
1 1/8" short spindle 5271  
Fits PA flush hub.  
CMS 1 1/4" spindle 5010  
For CMS hubs.



3/8" x 1 3/4" Hexhead Bolt  
Grade 5 3024 For pivot up`



3/8" x 1" Hex Bolt 3023  
Stainless steel



Socket Head Flat Screw -  
3/8" x 1" 3034 Stainless



3/8" x 1 1/2" Elevator Bolt  
Grade 5 3022 Stainless steel



3/8" x 1 1/2" Socket Head  
Cap Screw Grade 8 3021



3/8" Fender Washer  
3005 Zinc coated



3/8"-16 x 1-1/4" Hex Bolt  
Grade 5 Plated 3038



3/8"-16 x 1-1/2" Hex Bolt  
Grade 5 3039



3/8" x 3/4" Hex Bolt  
Grade 5 3037

### Metal Shafts 5036

Steel heel with aluminum shaft fronts. Powder coated black. Eye centers 43".



Adjustable  
Eyes 5149  
For double  
hitch pole.

### Pole 5140

Double hitch, aluminium with adjustable heel to fit shaft tabs from 44" centers to 42" centers. Powder coated black. Adjustable pole length to fit a variety of horses and ponies.

Total weight is 52 lbs.



### Pole 5138

Double hitch, aluminium for pivot-up



Pole Spring & Chain  
Assembly 5139



### Emergency Kit 5480

Everything you need to make a small repair on the road to get home safely.

# Air Bag Kit & Parts

## Market Wagon / Spring Wagon Kits

Reduce vibration and noise in a market wagon or spring wagon. Install on rear axles. Standard kit fits 1" and 1 1/8" axle. Also available for 1 1/4" axle. *Specify axle size when ordering.*



Kit with Airbags 5087-AB



Easily convert a noisy market wagon to a quieter ride.



Kit with Rubber Shocks 5087-RS



Spring Wagon Kit 5307 with 4 rubber shocks.



**Air Bag Bracket 5092**  
Powder coated black



**Air Bag Bracket Adjuster 5089**  
Powder coated black



**Air Bag Bracket Axle Mount 5090**  
Powder coated black



**Poly Tubing 5400**  
1/4" poly tubing used on all CMS air bag systems.



**Air Bag medium 5086**



**Rubber Shock 5360**



### 5200-ABKIT

This kit of items is used on our 5200-AB Torsion Gear, but can also be used on other gears. Check the list below to be sure this kit includes everything you need.

- 3023 Hex Bolt - 3/8" x 1" - stainless steel (8)
- 3034 Socket Head Flat Screw - 3/8" x 1" (8)
- 3101 Split Washer 3/8" Stainless steel (8)
- 5028 Air pump (1)
- 5029 Air pressure gauge, bracket (2)
- 5086 Air bag, medium (4)
- 5390 Air pressure gauge 60 psi (2)
- 5398 Brass tee, 1/8" NPT (2)
- 5399 Watts Air fill valve (2)
- 5400 Poly tubing, 1/4" (per foot) (25)
- 5401 Legris tee, 1/4" poly (2)
- 5403 Legris elbow, 1/8" NPT x 1/4" poly (2)
- 5410 Legris elbow, 1/4" NPT x 1/4" poly (4)



**Air Gauge 5390**  
60 PSI



**Air Gauge Panel Mount 5392**  
100 PSI



**Air Pump 5028**  
Hand-operated. Included with all gears and kits with air bags. Style and color may vary.



**Watts Air Fill Valve 5399**  
1/8" NPT. Use with standard hand pump or tire chuck.



**Brass Tee 5398**  
1/8" NPT



**Reducing Bushing 5405**  
1/4" NPT x 1/8" NPT. Brass. Fits into airbags.



**Legris Tee 5401**  
For 1/4" poly tubing



**Legris Tee 5402**  
1/8" NPT x 1/4" poly



**Legris Elbow 5410**  
1/4" NPT x 1/4" poly (fits into airbag)



**Legris Elbow 5403**  
1/8" NPT x 1/4" poly



**Legris Straight 5404**  
1/8" NPT x 1/4" poly



**1/4" Tubing Clip 5183**



**Self Drilling Screw Panhead #8 x 1/2" 3035** Stainless steel



### 5200-RSKIT

This kit of items is used on our 5200-RS Torsion Gear, but can also be used on other gears. Check the list below to be sure this kit includes everything you need.

- 3034 Flat Socket Head Cap Screw 3/8" x 1" (8)
- 3021 Flat Socket Head Cap Screw 3/8" x 1 1/2" SS (4)
- 3022 Elevator Bolt - 3/8" x 1 1/2" Grade 2 (4)
- 5360 Rubber Shock (4)
- 5159 Rubber Shock Plate (4)
- 3018 Nylon Lock Nut - Zinc plated 3/8" (16)
- 3005 3/8" Fender Washer (4)



**Air Gauge Bracket 5029**  
Powder coated black



**Mounting Plate 5195**  
for panel mount gauge



**Mounting Plate 5196**  
for air toggle switch



# Air Compressor & Parts



**NEW!**

**Air Manifold Assembly w/ 2 regulators w/ check valves and air compressor 5192**

- Recommended for carriages, buggies, and spring wagons
- Left side air bags go to left gauge & right side air bags go to right gauge. Or, front airbags to one gauge & rear to the other gauge.
- Simply adjust to preferred air pressure
- Regulators maintain air pressure in airbags and air compressor starts automatically when more air is needed and power is on
- Backup manual air fill valve to charge air reservoir if needed



**Aluminum Bracket to mount manifold under rear seat 5198**



*Shown with 5192 Manifold installed on 5198 bracket.*

**NEW!**



**Air Manifold Assembly w/ 2 paddle switches 5194**

- Recommended for carriages and buggies with equal weight front and back
- Left side air bags go to left gauge
- Right side air bags go to right gauge
- Fill and release switch for easy air pressure adjustment
- When power is on, air compressor starts automatically when more air is needed
- Backup manual air fill valve to charge air reservoir if needed



**Victor Compact Tire Inflator 5383**  
12 volt air compressor



**Pressure Switch 5382**  
Fixed Setpoint Pressure Switch, wire lead, 1/8 NPT Male Connection, 50 PSI Setpoint off 30 PSI Setpoint on



**Paddle Switch 5381**  
Paddle Seat Air Valve 3/16 barb



**Pressure Regulator 5380**  
Clippard Pressure Regulator, #10-32 Mainfold Mount, Knurled Knob, 10-50 psig



**Threaded Brass Bushing 5406**  
1/2 NPT male x 1/8" NPT female



**Compression Straight 5431**  
w/ 1 nut. 1/8" NPT male to 3/16" tube



**Compression Straight 5428**  
w/ 1 nut. 1/8" NPT female to 3/16" tube



**Compression Straight 5429**  
w/ 1 nut. 1/4" NPT male to 3/16" tube



**Plug 5432**  
w/ hex drive. 1/8" NPT w/ sealant.



**Rubber Ball 5384**  
for manifold check valve, 5/16".



**Compression Spring 5385**  
for manifold check valve, 1" long x 0.3 diameter.



**SS Face Plate 5192A-1**  
16 ga #4 polish, for manifold w/ regulators.



**SS Face Plate 5194A-1**  
16 ga #4 polish, for manifold w/ paddle switches.

# Disc Brakes & Parts

Kits contain parts for 2 wheels. Order 2 kits for 4 wheels. Master cylinder is not included in kits, but can be purchased separately on page 20.

*PLEASE NOTE: If you are mounting disc brakes on fiberglass or wooden wheels without channel, rubber, and steel, you can expect some rattle due to excessive vibration. Feel free to call with questions!*

## Disc Brake Kit w/ Covers for Regular Axles 5530-DC

Clamp-on bracket. Fits 1" or 1 1/8" axle.



## Disc Brake Kit for Regular Axles 5530

Clamp-on bracket. Fits 1" or 1 1/8" axle



## Disc Brake Kit for CMS 1 1/4" Hub

For gear with weld-on caliper bracket (not included).

..... 5533  
with covers..... 5533-DC



## Disc Brake Kit for 8 Bolt Hub 5534

For gear with weld-on caliper bracket (not included).



Also Available: Disc Brake Kits for Farmerstown Axle Systems  
5535 Fits 1 1/4" Farmerstown Axle    5536 Fits 1 1/2" Farmerstown Axle

Metal Disc 1/4" x 9 1/2". Zinc plated steel.



5041 For regular hub wheels

5043 For CMS 1 1/4" hub



Brakleen 5247  
Used to clean brake rotors and calipers.



Aluminum Disc Mount 5048  
For mounting discs to aluminum wheels.



Aluminum Disc Mount 5049  
For mounting discs to metal, wooden & fiberglass wheels.



Disc Covers 5100-P  
High-gloss black plastic.



Disc Cover Rubber 5186  
For #5100 disc covers.

## CMS Disc Brakes now compatible with... TROOPER by ROADEdge



Mounting holes in disc brakes are now provided for quick installation of the Trooper speedometer.



For more information, please contact Dashing Woodworks  
717-808-4315 405 Cains Road Gap, PA 17527



Caliper - 1/4" **5045**  
Disc brake wheel caliper



Caliper Pads  
**5046** Set of 4



Brake Pad Shims  
**5098** Set of 4. Available  
in .025" or .050" thickness.

### Caliper Brackets



Caliper Bracket  
**5340** For 1" and 1 1/8"  
axle. Powder coated  
black. Tightens against  
all 4 sides of the axle,  
creating less movement  
caused by vibration.



Caliper Bracket  
w/ Disc Cover  
Attachment **5342**  
For 1" and 1 1/8" axle.  
Powder coated black.  
Tightens against all  
4 sides of the axle,  
creating less movement  
caused by vibration.



**5116** 3/8" raw steel

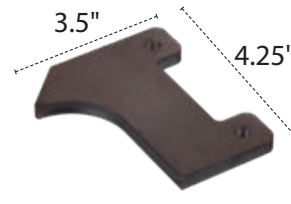

**5118** 3/8" raw steel

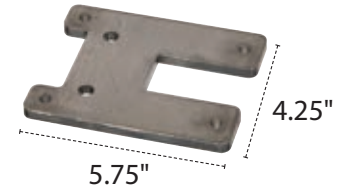

**5113** For disc cover.  
3/8" raw steel.

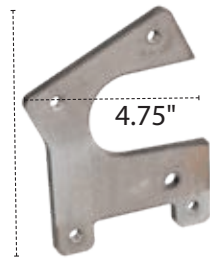

**5343** For disc cover.  
3/8" raw steel for torsion arm.



Rebuilding a  
CMS caliper?  
Here's what  
you need!

CMS part numbers  
are listed in green.

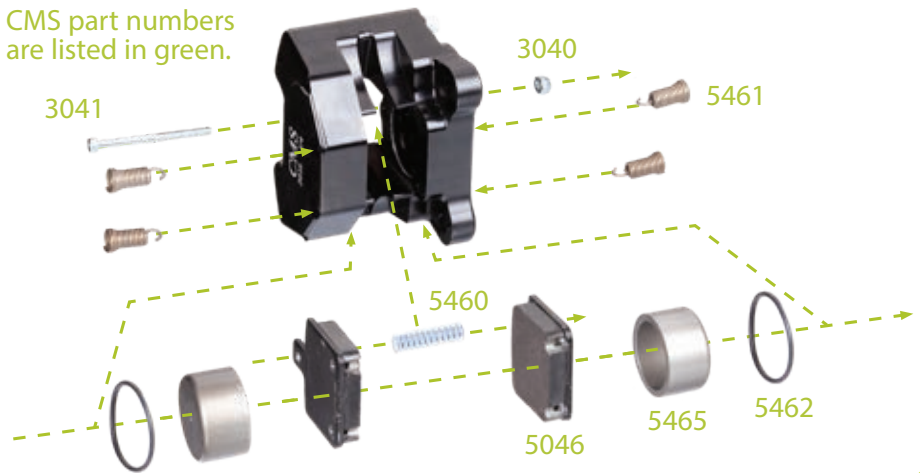

Helpful  
Tool

The perfect solution for installing pads in the CMS Caliper!

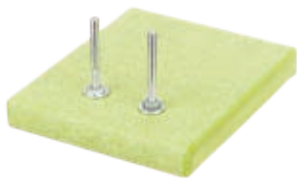

Disc Brake Caliper  
Pad Assembly Tool  
**5244**



**1** Put springs #**5461**  
into holes in caliper.



**2** Set caliper on  
assembly tool.



**3** Push down on caliper &  
slide pad in until both  
springs hook into pad.



**4** Repeat for  
second pad.

## Master Cylinder Assembly

5558 1" with check valve (for drum)

5559 1" w/o check valve (for disc)

5560 1 1/8" w/o check valve (for disc)



Pedal Arm Spring 5549  
Black zinc coated



Brake Eyelette 5020  
Brake pedal ball joint.



Pedal Cap 5127  
Aluminum, 3/8" thread hole



Hex Nut 3003  
5/16 - 24. Zinc.



Master Cylinder  
Rebuild Kit  
5561-RB



Replacement Cap  
for MC 5564



Master Cylinder  
Bracket Only  
5566  
Powder coated black

Master Cylinder  
Only



5561 1" w/o check valve (for disc)  
5562 1 1/8" w/o check valve (for disc)  
5563 1" with check valve (for drum)



1/2" Igus Bearing 5185  
Used to increase durability at the  
pivot point in the master cylinder.



Master Cylinder  
Plunger Rod 3002  
5/16-24 X 3 1/4" threaded rod.  
Stainless steel.

These three items may be used  
to clean out disc bolt threads  
on CMS 1 1/4" hub wheels.



6mm-10 Tap 5439



6mm Thread Cleaner 5438



6M x 1.0 Thread Form 5440



Stainless Steel  
Bleeder Screw w/  
Brass Bushing 5469



3/8" Nylon Lock Nut  
3018 Zinc plated



#10-24 Nylon  
Lock Nut 3040



Bleeder Screw  
5468 Stainless steel



Caliper Shim  
5097 3/8" ID x .020" thick

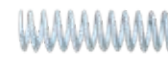

Caliper Spring 5460  
3/8" x 1 1/4" spring goes  
between pads.



Bleeder Screw  
Bushing 5467  
Brass



Split Washer 5/16"  
3100 Stainless steel



Caliper Spring 5461  
Keeps tension on pads  
to eliminate rattle.



3/8" x 1 1/4" Grade 8  
Hexhead Bolt 3028  
For calipers



Split Washer 3/8"  
3101 Stainless steel



O-Ring 5462  
Caliper piston O-ring



Socket Head Cap  
Screw Grade 5 -  
5/16" x 1 1/4" 3031



Flat Washer 3/8"  
3102 Stainless steel



Caliper Piston 5465  
For 1/4" caliper



Socket Head Cap  
Screw Grade 5 -  
5/16" x 3/4" 3032



3/8" x 3/4" Hex Bolt  
Grade 5 3037



O-Ring Lubricant  
5463



Socket Head Cap  
Screw 6mm x 3/4"  
3033 Stainless steel



#10-24 x 2 1/2" Hex  
Cap Screw Bolt  
Grade 5 3041

Use on pistons  
and o-rings when  
rebuilding a disc  
brake caliper

## Brake Fittings



### 3/16" Brake Tubing

High pressure brake tubing is available in 100, 500 & 2000-ft. rolls.

- 5420 .....per foot
- 5420-100.....100 ft. roll
- 5420-500.....500 ft. roll
- 5420-2000.....2,000 ft. roll

### Tubing Cutter 5246



### Replacement Blade 5245



**Loctite Thread Locker 263**  
5450 To be used on disc fasteners. 1.69 oz.



**Loctite Thread Sealant 545**  
5451 Recommended for use on disc brakes or air bag fittings. Use in place of Teflon tape. 1.69 oz.



**3/16" Tubing Clip**  
5184



**Self Drilling Screw  
Panhead #8 x 1/2"**  
3035  
Stainless steel



**Brake Fluid DOT 3**  
5277  
12 oz.

## Compression Fittings

- Fits hydraulic disc or drum brakes.
- Solid brass (no-rust)



**Compression Tee**  
5421



**Compression Elbow** 5422  
Fits master cylinder & disc brake calipers.



**Compression Straight** 5423  
Fits drum brakes.

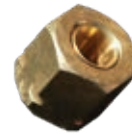

**Compression Nut** 5424



**Brake Lock Valve**  
5430



**Mounting Bracket**  
5393 for Brake Lock Valve & Air Valve



**Compression Elbow** 5422

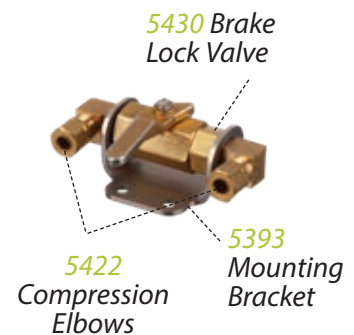

Items sold separately.  
Shown assembled for reference.

## Miscellaneous Buggy Parts



Light Bracket w/ Bridle Hook  
Powder coated black.  
2004 ..... black powder coated  
2004-SS ..... stainless steel



Light Bracket for Buggy w/ Bridle Hook  
Powder coated black.  
2260



Mirror Bracket  
Powder coated black.  
2148-S ..... short (4 1/8")  
2148-M ..... medium (5 1/8")  
2148-L ..... long (6 1/8")



Mirror Bracket  
Stainless steel  
2235-M ..... medium (5 1/8")  
2235L ..... long (6 1/8")



Window Holdup  
Powder coated black.  
Fits Amish carriage boxes.  
2228-N narrow 1 1/4"  
2228-W wide 2 1/4"

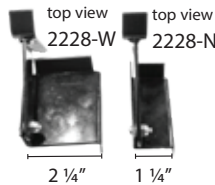

Window Holdup - Mennonite Style  
2228-M  
Powder coated black.  
Fits most Mennonite carriage boxes.



Roller Irons 5279  
With nylon rollers. Very quiet & durable.  
Used for steel rims or rubber tire.



Mudsplasher Strips  
5178  
1/8" x 1" aluminium strip.  
Specify length: 29 1/2", 32", 35", 37", 39"



Mudsplasher J-Clips  
Stainless, with bolts  
5172 ..... 7/8"

Extra Bolts, Nuts & Washers  
for Mudsplasher J-Clips  
5173-BP 50 pc. pack



Bio Plastic Eyelette  
5174 For J-Clip



Spring Link  
1/4" x 1" metal with radius ends. Raw steel.  
2250 .. 1 1/4" hole center  
2251 .. 1 1/2" hole center  
2252 ..... 2" hole center



Buggy Jack 2039  
Black powder coated. Makes wheel washing a breeze.

## Automotive Paints & Primers



DTR & DTM Black Urethane Primer HP5311  
Direct to rust / rust converter. Very high build acrylic urethane primer. Wood grain, etc. filler. Direct to metal application. 3-4 hour sanding time @ 80 degrees. 1 hour pot life. 4:1 mixing ratio w/ HH3100. 1 1/2 gal kit



HP662 DTA Black 2K Epoxy Primer HP662  
Direct to anything application with excellent adhesion. 10 day topcoat window. Not a sanding primer. Direct to rust, has rust converter. 2 gal kit



DURAFLINT 9044 - Black Paint HC9044  
Excellent gloss and color retention. 8 hour assembly time, 2 week full cure. 6 hour pot life. 10 year gloss. Can be used in direct to metal application. Comparable to U280. 1 gal kit



# PENNSYLVANIA EXEMPTION CERTIFICATE

- STATE AND LOCAL SALES AND USE TAX
- STATE 6% AND LOCAL 1% HOTEL OCCUPANCY TAX
- PUBLIC TRANSPORTATION ASSISTANCE TAXES AND FEES (PTA)
- VEHICLE RENTAL TAX (VRT)
- ADDITIONAL LOCAL, CITY, COUNTY HOTEL TAX \**

This form cannot be used to obtain a Sales Tax Account ID, PTA Account ID or Exempt Status.

(Please Print or Type)  
**Read Instructions  
On Reverse Carefully**

**THIS FORM MAY BE PHOTOCOPIED – VOID UNLESS COMPLETE INFORMATION IS SUPPLIED**

- CHECK ONE:**    **PENNSYLVANIA TAX UNIT EXEMPTION CERTIFICATE** (USE FOR ONE TRANSACTION)  
 **PENNSYLVANIA TAX BLANKET EXEMPTION CERTIFICATE** (USE FOR MULTIPLE TRANSACTIONS)

**Name of Seller, Vendor or Lessor**  
 Carriage Machine Shop, LLC

Street 250 Maple Ave	City Bird-in-Hand	State PA	ZIP Code 17505
-------------------------	----------------------	-------------	-------------------

**NOTE:** Do not use this form for claiming an exemption on the registration of a vehicle. To claim an exemption from tax for a motor vehicle, trailer, semi-trailer or tractor with the PA Department of Transportation, Bureau of Motor Vehicles, use one of the following forms:

- FORM MV-1**, Application for Certificate of Title (first-time registrations)
- FORM MV-4ST**, Vehicle Sales and Use Tax Return/Application for Registration (other registrations)

Property and services purchased or leased using this certificate **are exempt** from tax because: (Select the appropriate paragraph from the back of this form, check the corresponding block below and insert information requested).

- 1. Property or services will be used directly and predominately by purchaser in performing purchaser's operation of: \_\_\_\_\_
- 2. Purchaser is a/an: \_\_\_\_\_ holding Sales Tax Exemption Number \_\_\_\_\_
- 3. Property will be resold under Account ID \_\_\_\_\_ (If purchaser does not have a PA Sales Tax Account ID, include a statement under Number 8 explaining why a number is not required).
- 4. Property or services will be used directly and predominately by purchaser performing a public utility service.  
 PA Public Utility Commission PUC Number \_\_\_\_\_ and/or  U.S. Department of Transportation MC/MX \_\_\_\_\_
- 5. Exempt wrapping supplies, Account ID \_\_\_\_\_ (If purchaser does not have a PA Sales Tax Account ID, include a statement under Number 8 explaining why a number is not required).
- 6. Canned computer software purchased by a financial institution subject to the Bank and Trust Company Shares Tax (Article VII) or the Mutual Thrift Institutions Tax (Article XV).
- 7. Canned computer software licenses that are billed to a PA address but used outside of PA. The total number of software licenses purchased for invoice # \_\_\_\_\_ is \_\_\_\_\_. The total number of users accessing and using the software outside PA is \_\_\_\_\_.
- 8. Other \_\_\_\_\_  
 (Explain in detail. Additional space on reverse side).

I am authorized to execute this certificate and claim this exemption. Misuse of this certificate by seller, lessor, buyer, lessee or their representative is punishable by fine and imprisonment.

<b>Name of Purchaser or Lessee</b>	Signature	EIN	Date
Street	City	State	ZIP Code

- 1. ACCEPTANCE AND VALIDITY:**  
 For this certificate to be valid, the seller/lessor shall exercise good faith in accepting this certificate, which includes: (1) the certificate shall be completed properly; (2) the certificate shall be in the seller/lessor's possession within 60 days from the date of sale/lease; (3) the certificate does not contain information which is knowingly false; and (4) the property or service is consistent with the exemption to which the customer is entitled. For more information, refer to Exemption Certificates, Title 61 PA Code §32.2. An invalid certificate may subject the seller/lessor to the tax.
- 2. REPRODUCTION OF FORM:**  
 This form may be reproduced but shall contain the same information as appears on this form.
- 3. RETENTION:**  
 The seller or lessor must retain this certificate for at least four years from the date of the exempt sale to which the certificate applies.  
**⚠ IMPORTANT: DO NOT RETURN THIS FORM TO THE PA DEPARTMENT OF REVENUE.**
- 4. NONPROFIT EXEMPT ORGANIZATIONS:**  
 This form may be used in conjunction with form REV-1715, Exempt Organization Declaration of Sales Tax Exemption, when a purchase of \$200 or more is made by an organization which is registered with the PA Department of Revenue as an exempt organization. These organizations are assigned an exemption number, beginning with the two digits 75 (example: 75000000).



# METAL WHEEL ORDER SHEET

CUSTOMER \_\_\_\_\_  
 PO# \_\_\_\_\_  
 PHONE# \_\_\_\_\_  
 ORDER DATE \_\_\_\_\_  
 COMPLETION \_\_\_\_\_

ADDRESS \_\_\_\_\_  
 \_\_\_\_\_  
 \_\_\_\_\_  
 SHIP VIA \_\_\_\_\_

**#5500  
REGULAR HUB, LONG SPINDLE**

36" \_\_\_\_\_  
 38" \_\_\_\_\_  
 40" \_\_\_\_\_  
 42" \_\_\_\_\_

**#5501  
FLUSH HUB, SHORT SPINDLE**

36" \_\_\_\_\_  
 38" \_\_\_\_\_  
 40" \_\_\_\_\_  
 42" \_\_\_\_\_

**#5502  
CMS 1 1/4"**

36" \_\_\_\_\_  
 38" \_\_\_\_\_  
 40" \_\_\_\_\_  
 42" \_\_\_\_\_

**BRAKES INSTALLED**

DISC ON FRONT \_\_\_\_\_  
 DISC ON REAR \_\_\_\_\_  
 DRUM ON FRONT \_\_\_\_\_  
 DRUM ON REAR \_\_\_\_\_

**RUBBER & RIM OPTIONS**

FLAT RUBBER \_\_\_\_\_  
 HALF ROUND RUBBER \_\_\_\_\_  
 RUBBER & FLAT STEEL \_\_\_\_\_  
 LOW PROFILE RUBBER  
& FLAT STEEL \_\_\_\_\_  
 RUBBER & HALF ROUND STEEL \_\_\_\_\_  
 LOW PROFILE RUBBER &  
HALF ROUND STEEL \_\_\_\_\_  
 NONE \_\_\_\_\_

NOTES: \_\_\_\_\_  
 \_\_\_\_\_  
 \_\_\_\_\_  
 \_\_\_\_\_  
 \_\_\_\_\_  
 \_\_\_\_\_  
 \_\_\_\_\_





# TORSION GEAR

## ORDER SHEET

CUSTOMER \_\_\_\_\_  
 PO# \_\_\_\_\_  
 PHONE# \_\_\_\_\_  
 ORDER DATE \_\_\_\_\_  
 COMPLETION \_\_\_\_\_

ADDRESS \_\_\_\_\_  
 \_\_\_\_\_  
 \_\_\_\_\_  
 SHIP VIA \_\_\_\_\_

### GEAR TYPE

AIRBAG or RUBBER SHOCK #5200 \_\_\_\_\_ AB / RS  
 AIRBAG or RUBBER SHOCK #5201 \_\_\_\_\_ AB / RS  
 AIRBAG/SPRING or RUBBER SHOCK #5204 \_\_\_\_\_ AB / RS  
 EZ SPRING #5205 \_\_\_\_\_  
 EZ SPRING #5206 \_\_\_\_\_  
 EZ SPRING #5207 \_\_\_\_\_  
 EZ SPRING #5208 \_\_\_\_\_  
 STRAIGHT AXLE #5210 \_\_\_\_\_  
 STRAIGHT AXLE #5211 \_\_\_\_\_  
 STRAIGHT AXLE (AB or RS) #5212 \_\_\_\_\_ AB / RS

### WHEELS

36 X 40" METAL \_\_\_\_\_  
 38" X 42" METAL \_\_\_\_\_  
 NONE \_\_\_\_\_  
 CUSTOM SIZE \_\_\_\_\_

### WHEEL RIM OPTIONS

FLAT RUBBER \_\_\_\_\_  
 HALF ROUND RUBBER \_\_\_\_\_  
 RUBBER & FLAT STEEL \_\_\_\_\_  
 LP RUBBER & FLAT STEEL \_\_\_\_\_  
 RUBBER & HALF ROUND STEEL \_\_\_\_\_  
 LP RUBBER & HALF ROUND STEEL \_\_\_\_\_

### SHAFTS

PIVOT UP METAL \_\_\_\_\_  
 SINGLE TREE YES NO \_\_\_\_\_  
 SPRING TREE CHROME BLACK \_\_\_\_\_

### SHAFT ATTACHMENTS

PLATE FOR PIVOT UP \_\_\_\_\_  
 TABS FOR REGULAR SHAFTS \_\_\_\_\_  
 CUSTOM ATTACHMENT \_\_\_\_\_

### BRAKES

DISC ON FRONT \_\_\_\_\_  
 DISC ON REAR \_\_\_\_\_  
 DISC COVERS \_\_\_\_\_  
 DRUM ON FRONT \_\_\_\_\_  
 DRUM ON REAR \_\_\_\_\_  
 NONE \_\_\_\_\_

### MASTER CYLINDER

1" w/o CHECK VALVE (DISC) #5559 \_\_\_\_\_  
 1" w/ CHECK VALVE (DRUM) #5558 \_\_\_\_\_  
 OTHER \_\_\_\_\_

### AXLE SPINDLES

CMS 1 1/4" \_\_\_\_\_  
 LONG SPINDLE 1 1/8" \_\_\_\_\_  
 SHORT SPINDLE 1 1/8" \_\_\_\_\_

### ALUMINUM STRIP (AIR BAG ONLY)

REGULAR \_\_\_\_\_  
 SPLIT \_\_\_\_\_

### AIR MANIFOLD KIT

YES NO

*Fill out Manifold order sheet.*

### BODY BOX SIZE

(AIRBAG) \_\_\_\_\_

### SPRING CENTERS

(EZ SPRING) \_\_\_\_\_

### 5TH WHEEL STOP

YES NO

### WELD ON TABS FOR AXLE LIGHTS

YES NO

NOTES: \_\_\_\_\_



# MANIFOLD ORDER SHEET

CUSTOMER \_\_\_\_\_  
 PO# \_\_\_\_\_  
 PHONE# \_\_\_\_\_  
 ORDER DATE \_\_\_\_\_  
 COMPLETION \_\_\_\_\_

ADDRESS \_\_\_\_\_  
 \_\_\_\_\_  
 \_\_\_\_\_  
 SHIP VIA \_\_\_\_\_

**Gear #** \_\_\_\_\_

**Manifold Type**

- A. Clippard regulators with check valves \_\_\_\_\_
- B. Paddle switches x 2 without check valves \_\_\_\_\_
- C. Paddle switches x 4 without check valves \_\_\_\_\_

**Gauges**

- A. Mounted in manifold \_\_\_\_\_
- B. Remote gauges \_\_\_\_\_

**Mounting Position**

- A. Top shelf \_\_\_\_\_
- B. Under dash \_\_\_\_\_
- C. Under back seat \_\_\_\_\_

**Fittings**

- A. 1/4" Legris \_\_\_\_\_
- B. Compression \_\_\_\_\_

**Air Line Hookup to Airbags**

- A. 2 Air lines, left side - right side \_\_\_\_\_
- B. 4 air lines, one to each airbag \_\_\_\_\_

**Stainless Steel Face Plate**

**YES** \_\_\_ **NO** \_\_\_



# CARRIAGE PARTS

## ORDER SHEET

CUSTOMER \_\_\_\_\_  
 PO# \_\_\_\_\_  
 PHONE# \_\_\_\_\_  
 ORDER DATE \_\_\_\_\_  
 COMPLETION \_\_\_\_\_

ADDRESS \_\_\_\_\_  
 \_\_\_\_\_  
 \_\_\_\_\_  
 SHIP VIA \_\_\_\_\_

QTY	PART#	DESCRIPTION	PRICE	TOTAL

Revised 12/11/20

***ASK for these products  
at your local coach shop.***



**Keep Smiling!**



*250 Maple Ave. Bird-in-Hand, PA 17505*

***Please call for technical questions.  
Wholesale accounts: Call for quantity pricing.***